

MEASURING INSERT W2

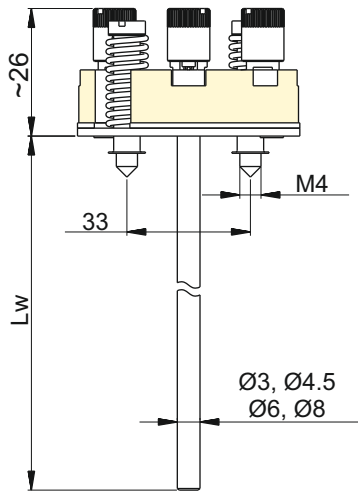

Measuring range of insert

Insert type	
W2	
Pt	-70÷500°C/-196÷150°C*
K	-40÷550°C/-40÷1000°C
S	
B	
Shield	316/Inconel

* - low temperature version

Ordering procedure

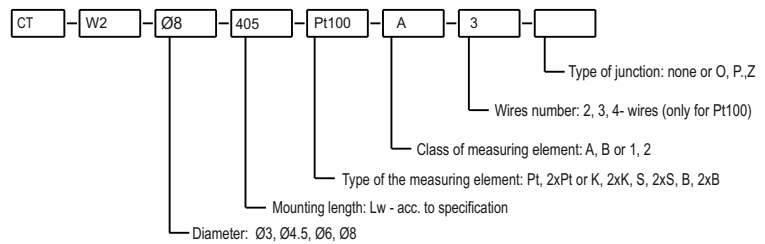

CLAMPING GRIPS FOR MOUNTING THE TEMPERATURE SENSORS

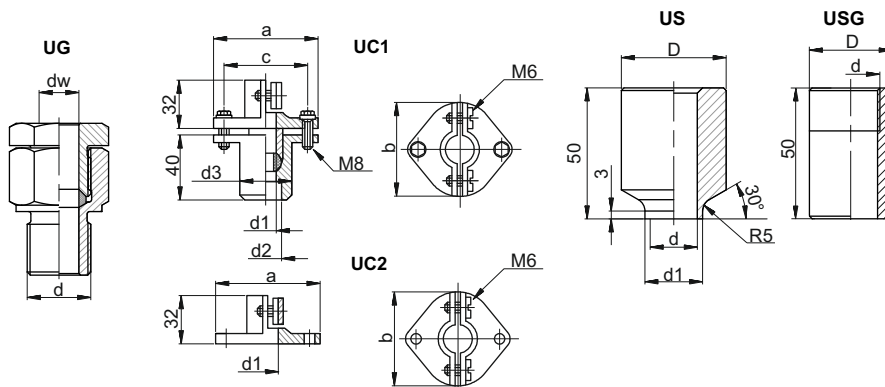

Type	Marking	External diameter of sensor's shield [mm]	Dimensions [mm]								Material		
			dw	d	a	b	c	d1	d2	d3		D	
	UG3	3	3.5	M20×1,5, G1/2", 1/2NPT									316
	UG6	6	6.5	M20×1,5, G1/2", 1/2NPT									
	UG12	12	12.5	M20×1,5, G1/2", 1/2NPT									
UC1	UC1-15	15			75	50	55	16	26	35			St30
	UC1-22	22			90	65	70	23	33	40			
UC2	UC2-15	15			75	50	55	16					
	UC2-22	22			90	65	70	23					
US	US18			Ø18/G7					22			40	316
	US24			Ø24/G7				30			50		
USG	USG-M20x1.5			M20×1,5								25	316
	USG-G1/2"			G1/2"									
	USG-1/2NPT			1/2NPT									

*Admissible load: UG - 8MPa, UC1 - 0,1MPa

Ordering procedure

